

**PERMIT**  
**CITY OF NAPOLEON - BUILDING DEPARTMENT**

255 West Riverview Avenue, Napoleon, Ohio 43545 - 419-592-4010

Permit No. 01973 Issued 5-3-90  
date

Job Location 1449 Ohio  
address

Lot 8 Bockelman's Third  
sub-div or legal discript

Issued By Eldon Huber  
building official

Owner George Higbea 592-5636  
name tel.

Address 1449 Ohio

Agent Dutchman Construction 599-2758  
builder-eng.-etc. tel.

Address Rt. #3 11-200 Rd. 0

Description of Use Residence

Residential 1  
no. dwelling units

Commercial \_\_\_\_\_ Industrial \_\_\_\_\_

New \_\_\_\_\_ Add'n. X Alter \_\_\_\_\_ Remodel \_\_\_\_\_

Mixed Occupancy \_\_\_\_\_

Change of Occupancy \_\_\_\_\_

Estimated Cost \$ 950.00

**ZONING INFORMATION**

district	lot dimensions	area	front yd	side yds	rear yd
A	76' X 100'+		Existing	L-15' R-Exist.	50'
max hgt	no pkg spaces	no ldg spaces	max cover	petition or appeal req'd	date appr
35'	2-min		35%		

**WORK INFORMATION:**

Size: Length 42' Width 12' Stories \_\_\_\_\_ Ground Floor Area 504  
 Height \_\_\_\_\_ Building Volume (for demo. permit) \_\_\_\_\_ cu. ft.

Electrical: \_\_\_\_\_ brief description \_\_\_\_\_

Plumbing: \_\_\_\_\_ brief description \_\_\_\_\_

Mechanical: \_\_\_\_\_ brief description \_\_\_\_\_

Sign: \_\_\_\_\_ type \_\_\_\_\_ Dimensions \_\_\_\_\_ Sign Area \_\_\_\_\_

Additional Information: A new patio will be added to the existing house as per  
the sketch attached

Date \_\_\_\_\_ Applicant Signature William H Behrfeldt 5-2-90  
owner-agent

FEE	BASE	PLUS	TOTAL
<input checked="" type="checkbox"/> BUILDING	9.00	9.00	18.00
<input type="checkbox"/> ELECTRICAL			
<input type="checkbox"/> PLUMBING			
<input type="checkbox"/> MECHANICAL			
<input type="checkbox"/> DEMOLITION			
<input type="checkbox"/> ZONING			
<input type="checkbox"/> SIGN			
<input type="checkbox"/> WATER TAP			
<input type="checkbox"/> SEW. INSP.			
<input type="checkbox"/> SEWER TAP			
<input type="checkbox"/> TEMP. WATER			
<input type="checkbox"/> TEMP. ELECT.			
ADDITIONAL PLAN REVIEW	Struct. _____ hrs		
	Elect. _____ hrs		
TOTAL FEES.....			18.00
LESS MIN. FEES PAID _____			
BALANCE DUE.....			

**PAID**

**MAY 02 1990**

**CITY OF NAPOLEON**

# INSPECTION RECORD

	UNDERGROUND			ROUGH-IN					FINAL			
	Type	Date	By	Type	Date	By	Type	Date	By	Type	Date	By
<b>PLUMBING</b>	Building Drains			Drainage, Waste & Vent Piping			Indirect Waste			Drainage, Waste & Vent Piping		
	Water Piping									Backflow Prevention		
	Building Sewer			Water Piping			Condensate Lines			Water Heater		
	Sewer Connection									FINAL APPROVAL		
<b>MECHANICAL</b>	Refrigerant Piping			Refrigerant Piping			Chimney(s)			Grease Exhaust System		
				Duct Furnace(s)			Fire Dampers			Air Cond. Unit(s)		
	Ducts/ Plenums			Ducts/ Plenums			<input type="checkbox"/> Radiant Htr(s) <input type="checkbox"/> Unit Htr(s)			Refrigeration Equipment		
				Duct Insulation			Pool Heater			Furnace(s)		
				Combustion Products Vents			Ventilation <input type="checkbox"/> Supply <input type="checkbox"/> Exhst.			FINAL APPROVAL		
<b>ELECTRICAL</b>	Conduits & or Cable			Conduits/ Cable			<input type="checkbox"/> Range <input type="checkbox"/> Dryer			Temp Service Temp Lighting		
	Grounding & or Bonding			Rough Wiring			<input type="checkbox"/> Generator(s) <input type="checkbox"/> Motors			Fixtures Lampholders		
	Floor Ducts Raceways			Service Panel Switchboard			<input type="checkbox"/> Water Htr <input type="checkbox"/> Welder			Signs		
	Service Conduit			Busways Ducts			<input type="checkbox"/> Heaters <input type="checkbox"/> Heat Cable			Electric Mtr. Clearance		
	Temporary Power Pole			Subpanels			<input type="checkbox"/> Duct Htr(s) <input type="checkbox"/> Furnace(s)			FINAL APPROVAL		
<b>BUILDING</b>	Location, Set-backs, Esmt(s)			Exterior Wall Construction			Roof Covering Roof Drainage			Smoke Detector		
	Excavation						Exterior Lath			Demolition (sewer cap)		
	Footings & Reinforcing						<input type="checkbox"/> Interior Lath <input type="checkbox"/> Wallboard					
	Floor Slab			Interior Wall Construction			Fire Wall(s)			Building or Structure		
	Foundation Walls			Columns & Supports			Fireplace Chimney					
	Sub-soil Drain			Crawl Space <input type="checkbox"/> Vent <input type="checkbox"/> Access			Attic <input type="checkbox"/> Vent <input type="checkbox"/> Access					
	Piles			Floor System(s)						FINAL APPROVAL BLDG. DEPT.	7/3	BD
			Roof System			Special Insp Reports Rec'd			Certificate of Occupancy Issued			
<b>ADDITIONAL</b>	INSPECTIONS, CORRECTIONS, ETC.						INSPECTIONS, CORRECTIONS, ETC.					

APPLICATION  
for  
RESIDENTIAL BUILDING, ELECTRICAL, PLUMBING, MECHANICAL, PERMITS and DEMOLITION PERMIT  
from the  
CITY OF NAPOLEON - BUILDING DEPARTMENT  
255 West Riverview Ave. Napoleon, Ohio 43345 Pn. 419-592-4010

Entry No. \_\_\_\_\_

Permit No. 01977 Issued 5-3-90

Job Location 1449 Ohio

Lot 8 ROCKELMANS THIRD  
sub-div. or legal disc.

Issued By FH  
building official

Owner George Higbee Pn 592-5636

Address 1449 Ohio Napoleon

Agent Dutchmen Const Pn 599-2758  
11-200 RDO

Address R+#3 Napoleon

Description of Use New patio

Residential 1  
no. dwelling units

Commercial \_\_\_\_\_ Industrial \_\_\_\_\_

New \_\_\_\_\_ Add'n. X Alter \_\_\_\_\_ Remodel \_\_\_\_\_

Mixed Occupancy \_\_\_\_\_

Change of Occupancy \_\_\_\_\_

Estimated Cost \$ 9500

**-ZONING INFORMATION**

district	lot dimensions	area	front yd	side yds.	rear yd
<u>A</u>	<u>76' x 100' 4"</u>	<u>7600</u>	<u>EXIST</u>	<u>6-15' R-EXIST</u>	<u>50'</u>
max hgt	no pkg spaces	no ldg spaces	max cover	petition or appeal req'd.	date appr
<u>30'</u>	<u>2-MR</u>		<u>35%</u>		

**WORK INFORMATION:**

BUILDING: Garage Fl. Area \_\_\_\_\_ Basement Fl. Area \_\_\_\_\_ Second Floor Area \_\_\_\_\_

Size: Length 42 Width 12 Stories \_\_\_\_\_ Ground Floor Area 508

Height \_\_\_\_\_ Building Volume (for dem. permit) \_\_\_\_\_ cu. ft.

Description of Work: a new patio will be added to the existing house as per the sketch attached

Ch. Permits Reg.	Base	Fees Plus	Total
<u>X</u> Building	<u>900</u>	<u>900</u>	<u>1800</u>
Electrical			
Plumbing			
Mechanical			
Demolition			
Zoning			
Sign			
Water tap			
Sewer Tap			
Temp. Water			
Temp. Elec.			
Additional plan review	struc. _____ hrs	Elect. _____ hrs	
Total Fees.....			<u>1800</u>
Less Min. Fees Pd.			
Balance Due.....			<u>1800</u>

Continue on Back Side for Electrical, Plumbing and Mechanical and other Information;

**PAID**  
**MAY 02 1990**  
CITY OF NAPOLEON



**ELECTRICAL: Electrical Contractor** \_\_\_\_\_ Pn. \_\_\_\_\_  
 Address \_\_\_\_\_ Estimated Cost \$ \_\_\_\_\_  
 Type of work: New \_\_\_\_\_ Service change \_\_\_\_\_ Rewiring \_\_\_\_\_ Additional Wiring \_\_\_\_\_ Temp. Elec. Req. \_\_\_\_\_  
 Size of service \_\_\_\_\_ Underground \_\_\_\_\_ Overhead \_\_\_\_\_ No. of new circuits \_\_\_\_\_  
 Description of work: \_\_\_\_\_

**PLUMBING: Plumbing Contractor** \_\_\_\_\_ Pn. \_\_\_\_\_  
 Address \_\_\_\_\_ Estimated Cost \$ \_\_\_\_\_  
 Water Tap Req. \_\_\_\_\_ Size \_\_\_\_\_ Type of Pipe \_\_\_\_\_ Water Dist. Pipe \_\_\_\_\_ type  
 San. Sewer Tap Req. \_\_\_\_\_ Size \_\_\_\_\_ Type of Pipe \_\_\_\_\_ Dr. Waste Vt. Pipe \_\_\_\_\_ type  
 St. Sewer Tap Req. \_\_\_\_\_ Size \_\_\_\_\_ Type of Pipe \_\_\_\_\_ Street to be Opened \_\_\_\_\_  
 Main Building Drain Size \_\_\_\_\_ Main Vent Pipe Size \_\_\_\_\_ List Number of Plumbing Fixtures Below  
 Water Closets \_\_\_\_\_ Bathtubs \_\_\_\_\_ Showers \_\_\_\_\_ Lavatories \_\_\_\_\_ Kitchen Sinks \_\_\_\_\_ Disposal \_\_\_\_\_ Dishwasher \_\_\_\_\_ Clothes Washer \_\_\_\_\_  
 Floor Drains \_\_\_\_\_ Other Fixtures: Type \_\_\_\_\_ No. \_\_\_\_\_  
 Description of Work: \_\_\_\_\_

**MECHANICAL: Mechanical Contractor** \_\_\_\_\_ Pn. \_\_\_\_\_  
 Address \_\_\_\_\_ Estimated Cost \_\_\_\_\_  
 Heating System: Forced Air \_\_\_\_\_ Gravity \_\_\_\_\_ Hot Water \_\_\_\_\_ Steam \_\_\_\_\_ Unit Heaters \_\_\_\_\_ Radiant \_\_\_\_\_ Baseboard \_\_\_\_\_  
 Type of Fuel: Electric \_\_\_\_\_ Natural Gas \_\_\_\_\_ Propane \_\_\_\_\_ Wood \_\_\_\_\_ Coal \_\_\_\_\_ Solar \_\_\_\_\_ Geothermal \_\_\_\_\_ Other \_\_\_\_\_  
 No. of Heat Zones \_\_\_\_\_ Hot Water: (One Pipe \_\_\_\_\_ Two Pipe \_\_\_\_\_ Series Loop \_\_\_\_\_) Electric Heat: (No of Circuits \_\_\_\_\_) No. of Furnaces \_\_\_\_\_  
 No. of Hot Air Runs \_\_\_\_\_ No. of Hot Water Radiators \_\_\_\_\_ Total Heat Loss \_\_\_\_\_ Rated Capacity of Furnace/Boiler \_\_\_\_\_  
 Location of Heating Units: Crawl Space \_\_\_\_\_ Floor Level \_\_\_\_\_ Attic \_\_\_\_\_ Suspended \_\_\_\_\_ Roof \_\_\_\_\_ Outside \_\_\_\_\_ Other \_\_\_\_\_  
 Description of Work \_\_\_\_\_

**DRAWINGS REQUIRED:** All Applications must be Accompanied by Two Complete sets of Drawings Including SITE PLAN, FOUNDATION PLAN, FLOOR PLANS, STRUCTURAL FRAMING PLANS, EXTERIOR ELEVATIONS, SECTIONS and DETAILS, STAIR DETAILS, ELECTRICAL LAYOUT, PLUMBING ISOMETRIC, HEATING LAYOUT ETC. All plans shall be DRAWN TO SCALE. Show all existing structures on the site plan also, show Electric Panel and Furnace Locations.

**READ AND SIGN BELOW;** The undersigned hereby makes application for a permit for all work described herein, and agrees to complete the work in strict accordance with all applicable provisions of the current edition of the C.A.B.D. Building Code, the Napoleon Building and Zoning Codes, the Napoleon Engineering Dept. Rules and Regulations, Standard Specifications and other Pertinent Sections of the Napoleon Code of Ordinances.

Date 4-30-90 Signature of Applicant W. H. Behrfeldt  
 Application not valid without signature

DEPT SO YAM  
 BOSTON MA 02108

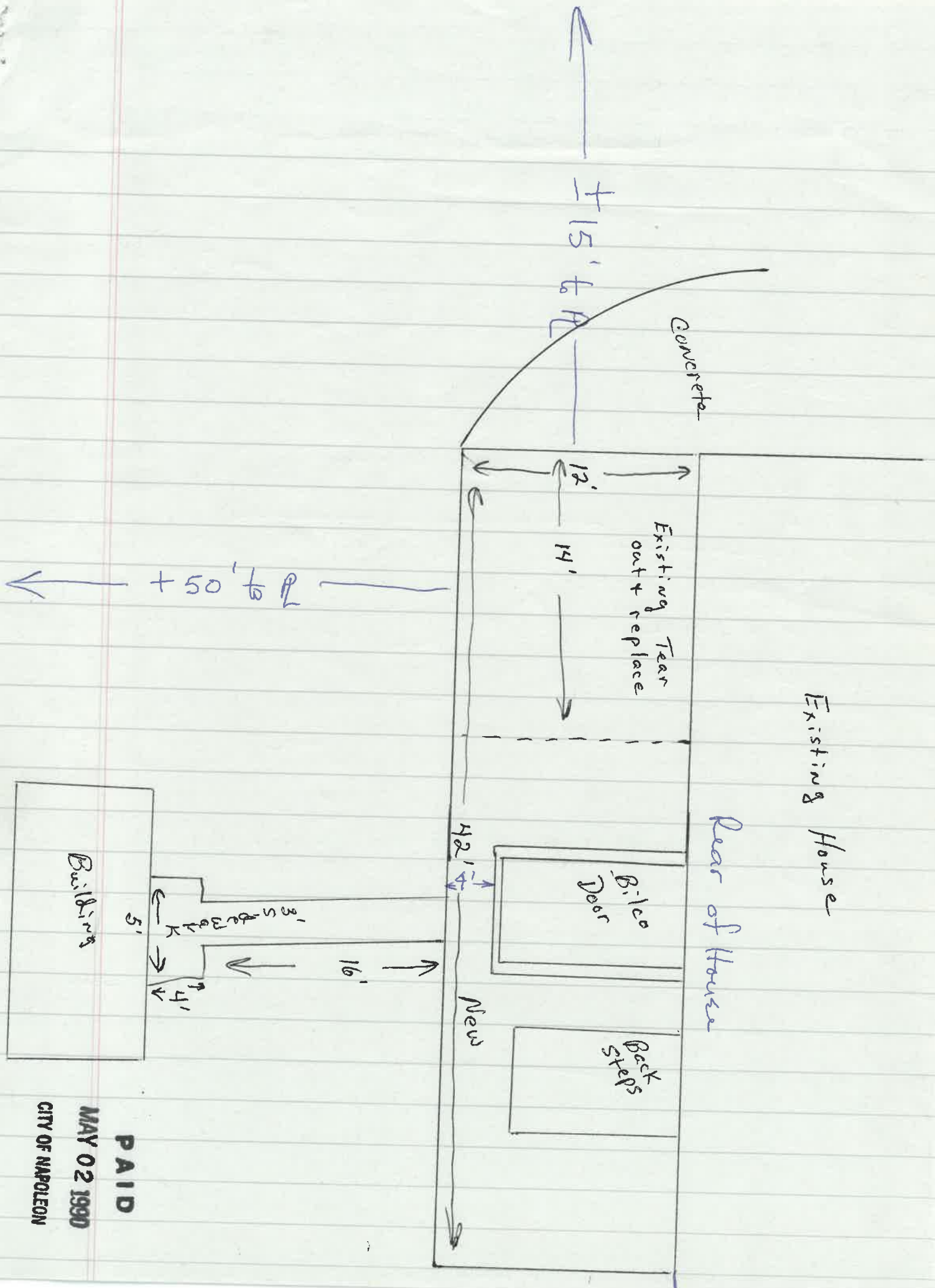

**PAID**

**MAY 02 1990**

**CITY OF NAPOLEON**

CIA DE WASHINGTON  
MAY 05 1960  
PAID